

An aerial photograph of Seattle, Washington, showing the city skyline and waterfront. The image is overlaid with a semi-transparent blue filter. The text is positioned in the upper left and center of the image.

**A GREAT WATERFRONT PARK NEEDS  
A GREAT COMMUNITY PARTNER.**

Friends of Waterfront Seattle is that partner.

**friends**  
of WATERFRONT SEATTLE



education



**LEADERSHIP**

convening

**FUNDRAISING**

advocacy

**STEWARDSHIP**

activation



A photograph of a crowded indoor event, likely a museum or gallery. The scene is filled with people of various ages and ethnicities, many holding drinks, suggesting a social gathering. In the background, there are large digital displays showing vibrant nature scenes, including autumn foliage and green landscapes. The text is overlaid in the center of the image.

**MONTHLY EVENTS: 7-8**  
**AVERAGE MONTHLY VISITORS: 600-700**  
**PUBLIC HOURS: WED-SUN, 12-5PM**

Welcome to  
the future of Seattle's Waterfront  
A WATERFRONT FOR ALL

ELLIOTT BAY SEAWALL

at Seattle's historic waterfront





## Why build a seawall?

Before modern-day Seattle was established and built, mudflats and tidelands sloped quickly into the deep water of Elliott Bay. The settlers soon built piers and tracks were soon laid on pilings so the railroads could get to the ships carrying passengers and freight. It wasn't long before rotting wood, unsanitary conditions and increasingly dangerous traffic set the stage for the seawall.

After decades of debate, Seattle's seawall was finally built along Washington Street north to Broad Street. The wall was built to allow ships to dock and serves as the foundation for the city. The tidelands behind it were filled in to provide space for railroads and commerce.

## Two reasons for replacement

### A weakened wall

Most of Seattle's seawall was built in the 1930s. The wall was built of steel sheet piling, a marine conditions have changed in the seawall face, and it is under Alaskan Way.

### Unhealthy habitat

When Seattle's seawall was built, mudflats, rock piles, and shading due to the wall's presence chose to live in the shallower water. The current habitat is not good.



Workers and motor vehicles shared the same street in front of Pioneer Square.

...helped to place enough dirt to...

...wars, waterfr... regard for its... area where the Green...

...hook salmon and bull trout—Endangered Species Act—and of this watershed. In 2005, a regime was developed to guide fish pro... The plan recognizes Seattle's migration route.



Years of the weaker structure have become weak and spongy over recent decades, unless they are reinforced with concrete.



Grasses are also used to stabilize the seawall's structure and provide these creatures with habitat.

...a tradition thousands of years old, catching fish in Puget Sound.

...States government and Tribal leaders signed the right of Tribal people to fish at their... these treaty-reserved rights meet subsistence needs of contemporary Indian people... that once formed the backbone of native... per time. Members of the Muckleshoot fish Tribe exercise their reserved treaty... places in Elliott Bay and the Tribes work... resources, restore marine habitat and... ers.





# HOTSPOT

PRESENTED BY **friends**

of WATERFRONT SEATTLE

FREE WEEKEND EVENTS ON THE **WATERFRONT**



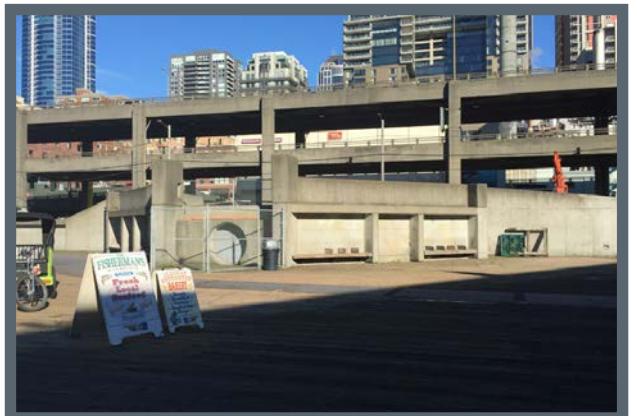
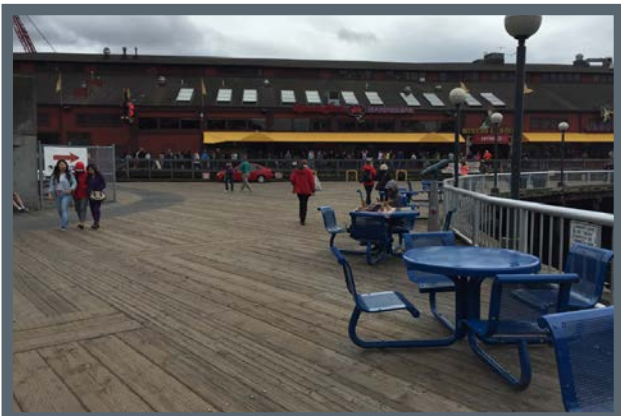
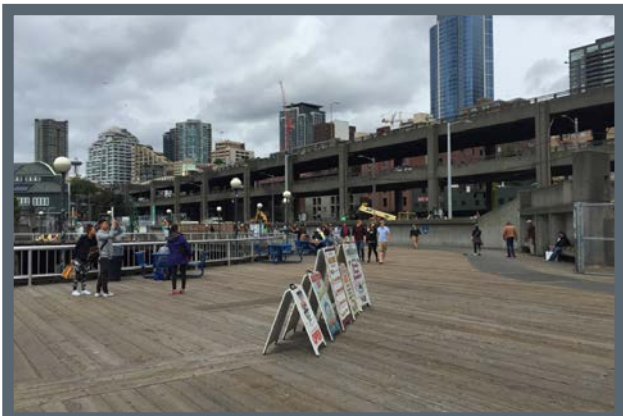
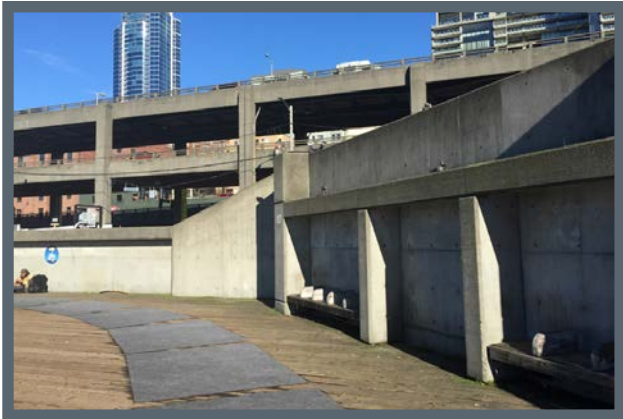

**WATERFRONT PARK - BEFORE HOT SPOT**

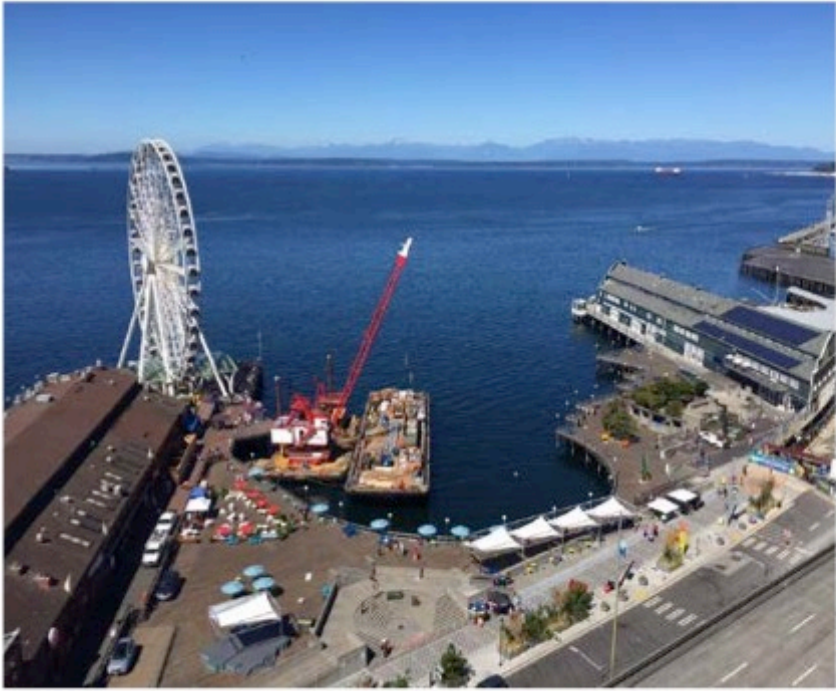

# KPOP NOW!



# KEXP ROCKS THE DOCK



# SOUNDERS RAVE FOUNDATION SOCCER



**WATERFRONT TODAY**  
VIEW SOUTH AT  
SENECA STREET



**WATERFRONT 2020**  
VIEW SOUTH AT  
SENECA STREET



# WATERFRONT STOREFRONT INITIATIVE

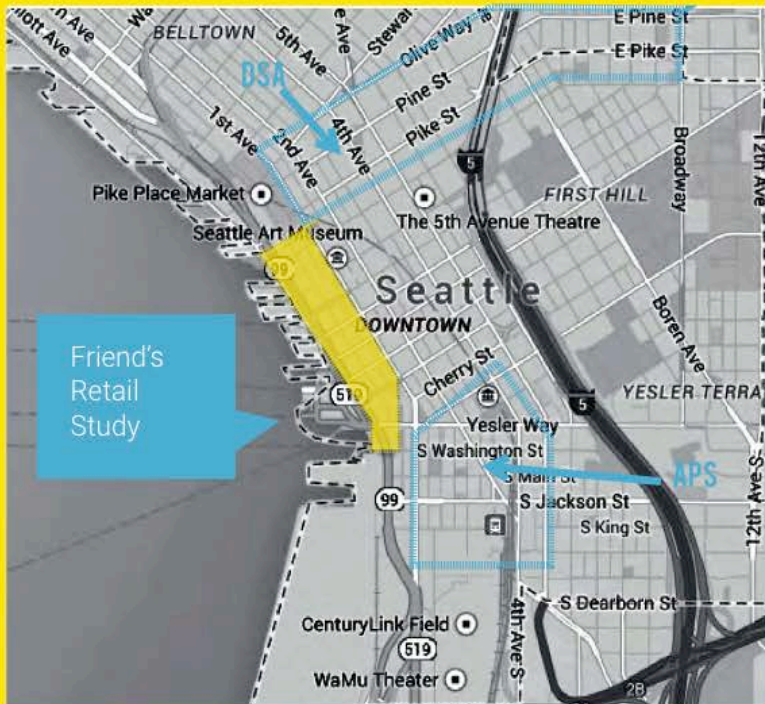

## URBAN RETAIL

activates the public realm



“Folks coming to the waterfront are looking for an experience”

-STAKEHOLDER INTERVIEWEE

## SUCCESSFUL RETAIL

contiguous, clustered operations

balanced day/night

narrower streets

human-scale buildings

well-maintained sidewalks

parking available

## STRENGTHS & OPPORTUNITIES

views of Elliott Bay and the Olympic Mountains

authentic feel

contrast of historical and modern

existing destinations - Pike Place Market and the Aquarium



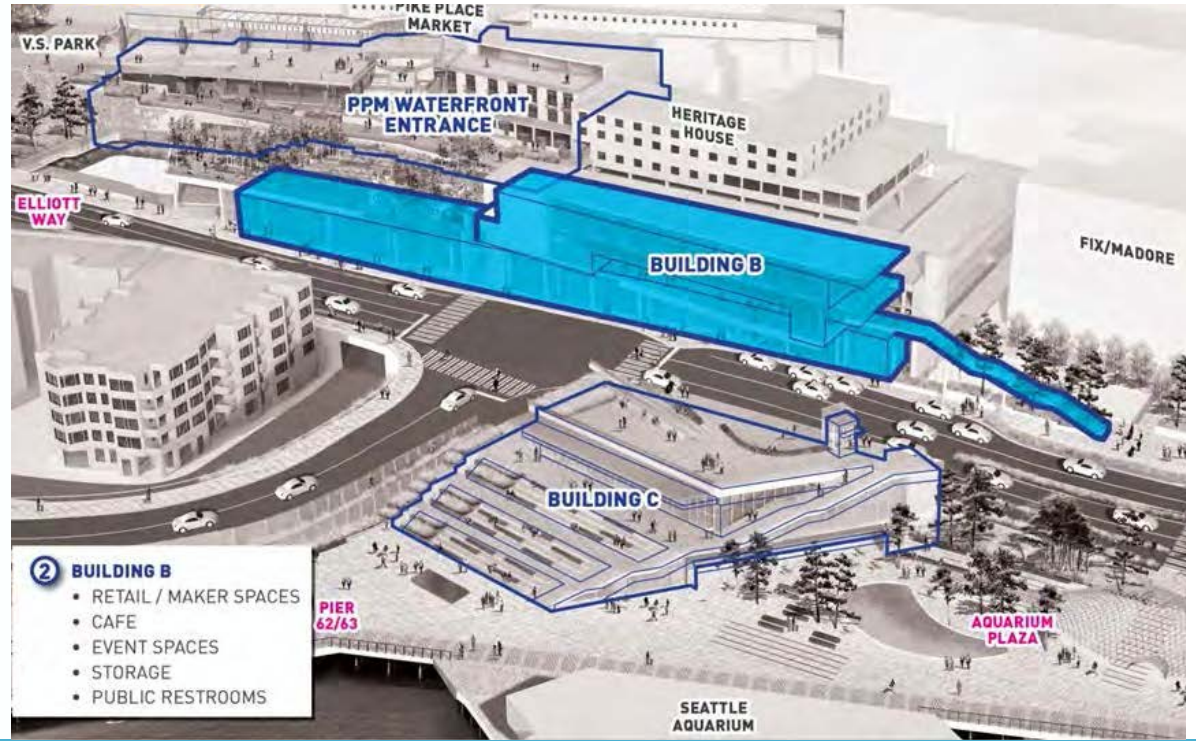

# PARK RETAIL OPPORTUNITIES

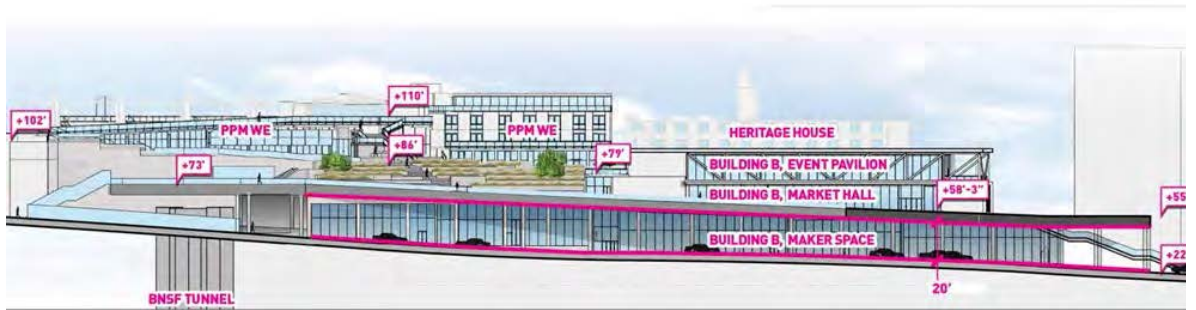



# PIER 62/63

## PROPOSED IMPROVEMENTS

### LEGEND

- ① REBUILT PIER 62
- ② NEW RAILING
- ③ FLOATING BOAT DOCK
- ④ LIGHT PENETRATION NEAR SHORE



# PIER 62/63

PRESENT



# PIER 62/63

FUTURE



# PIER 62/63

FUTURE



# PIER 62/63

FUTURE



# PIER 62/63

PROGRAM: ACTIVITY PIER

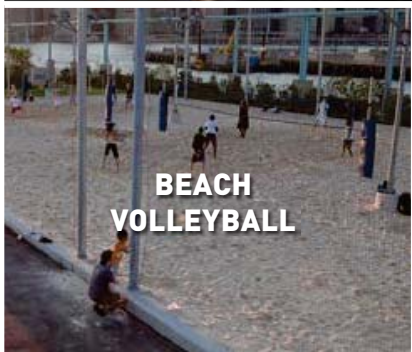
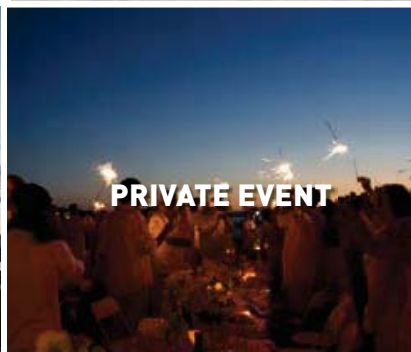

# PIER 62/63

## CAPACITY DIAGRAM

CONCERT: 6,000 PEOPLE

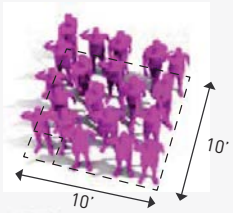

1 PERSON STANDING  
/ 5sqft

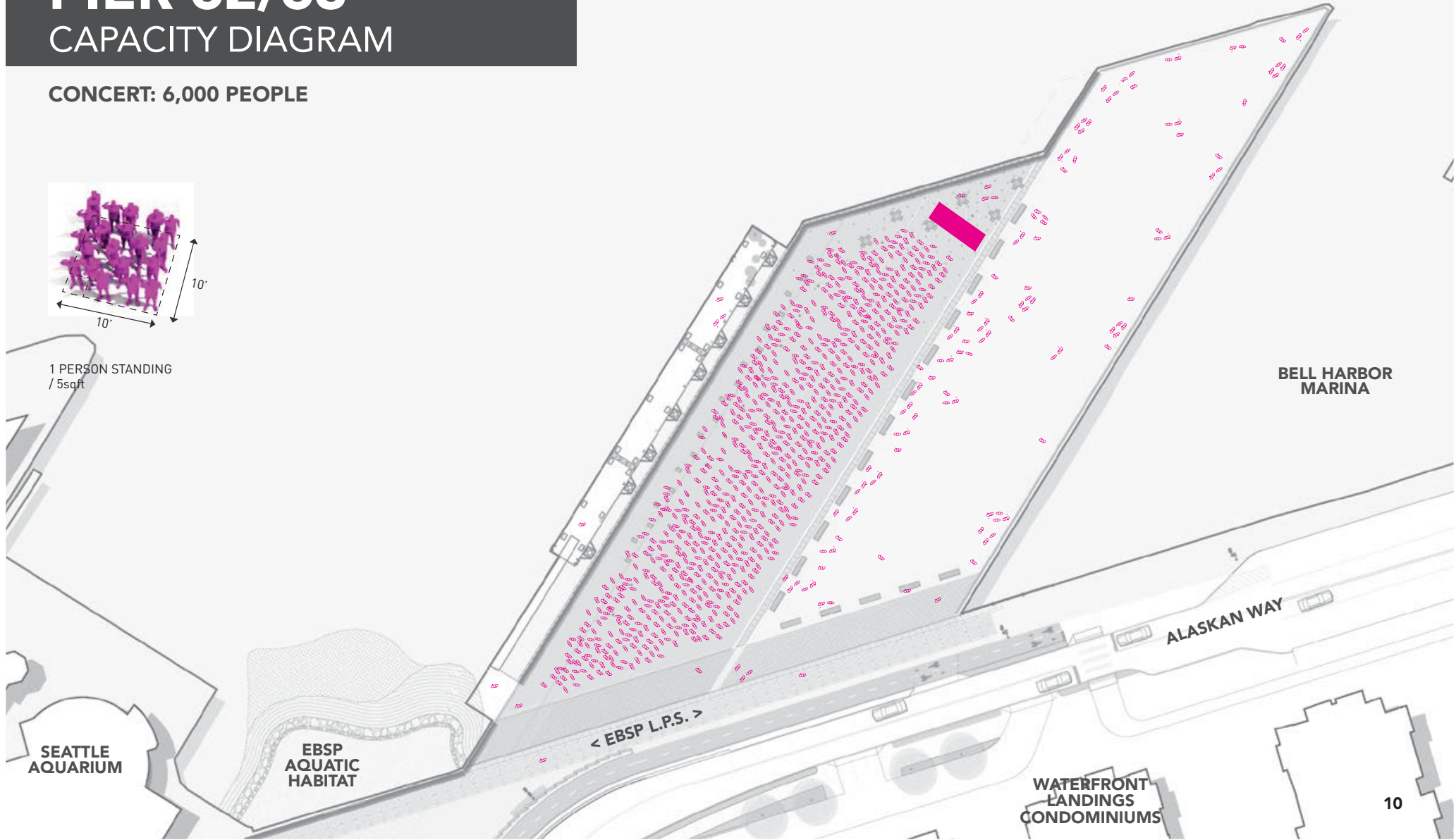

# PIER 62/63

## CAPACITY DIAGRAM

CONCERT: 500, 1,000, AND 1,500 PEOPLE EVENTS SEATED

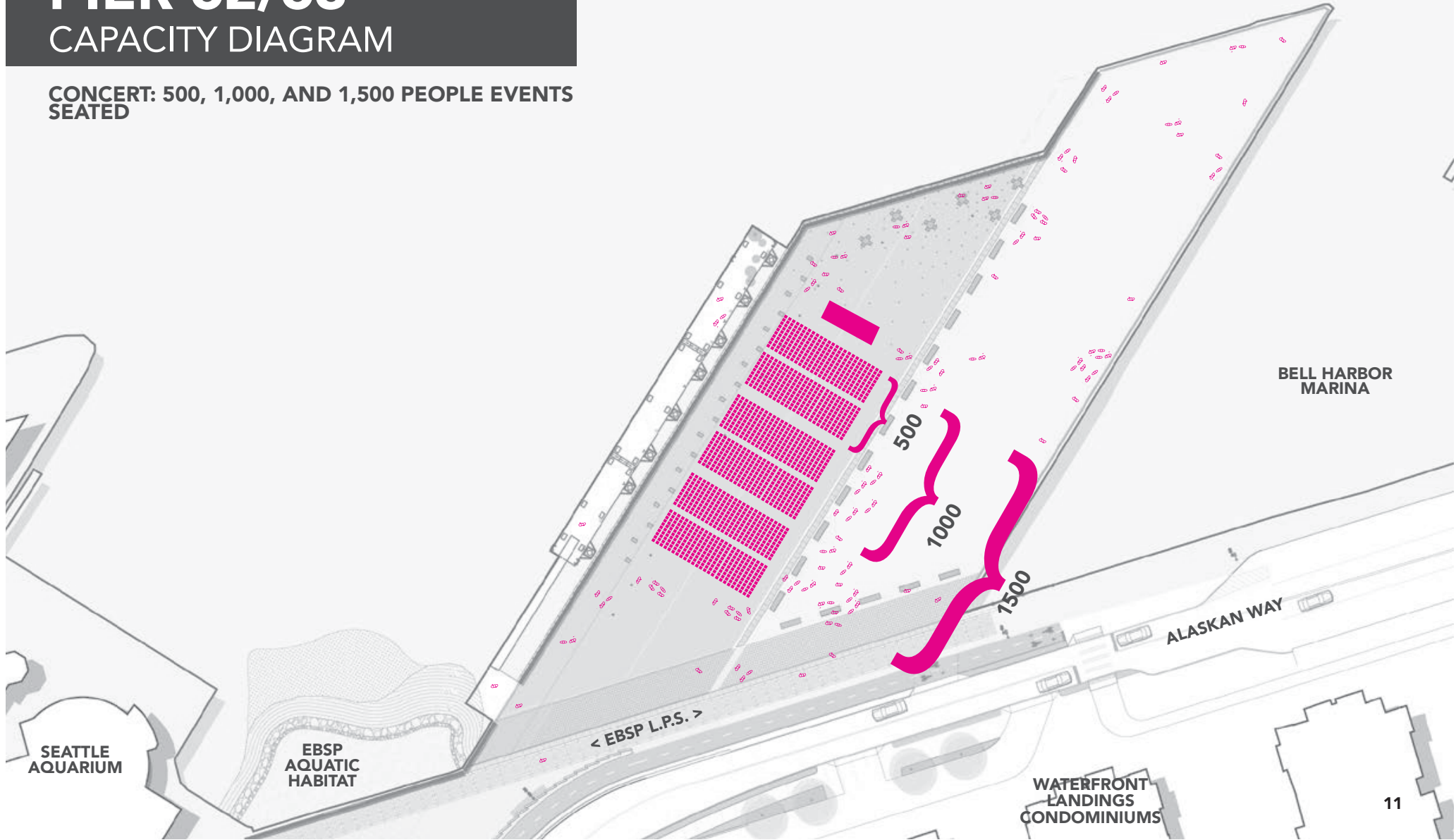

SEATTLE  
AQUARIUM

EBSP  
AQUATIC  
HABITAT

WATERFRONT  
LANDINGS  
CONDOMINIUMS

BELL HARBOR  
MARINA



# PIER 62/63

## ACTIVE PROGRAM OPTIONS

MINI SOCCER, BASKETBALL, VOLLEYBALL, TABLE TENNIS

### ① SOCCER PITCH

- 80 X 120
- 50 X 100

### ② BASKETBALL COURT

- 50 X 95

### ③ VOLLEYBALL COURT

- 60 X 30

### ④ TABLE TENNIS

- 9 X 5

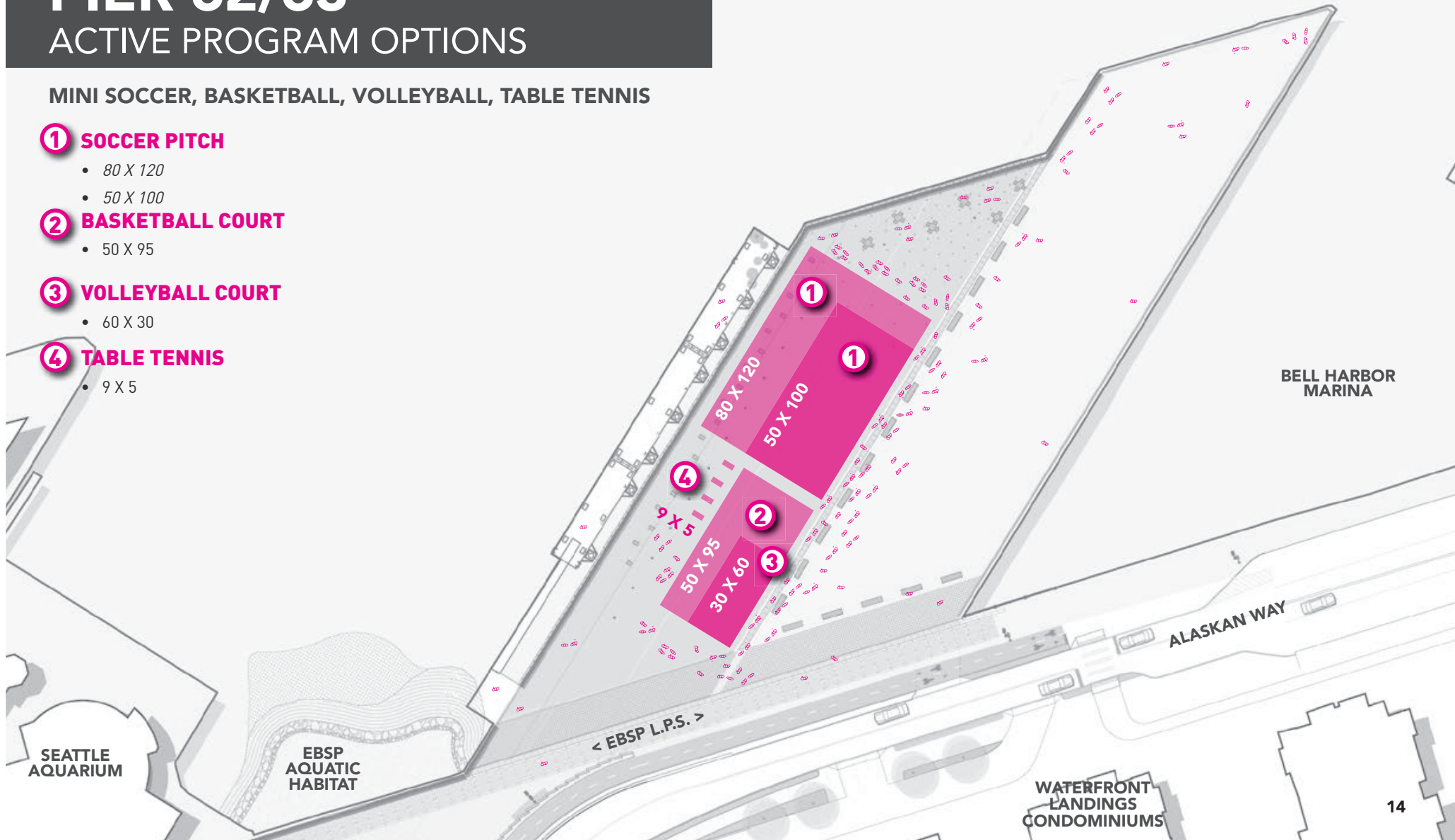

BELL HARBOR MARINA

ALASKAN WAY

SEATTLE AQUARIUM

EBSP AQUATIC HABITAT

< EBSP L.P.S. >

WATERFRONT LANDINGS CONDOMINIUMS

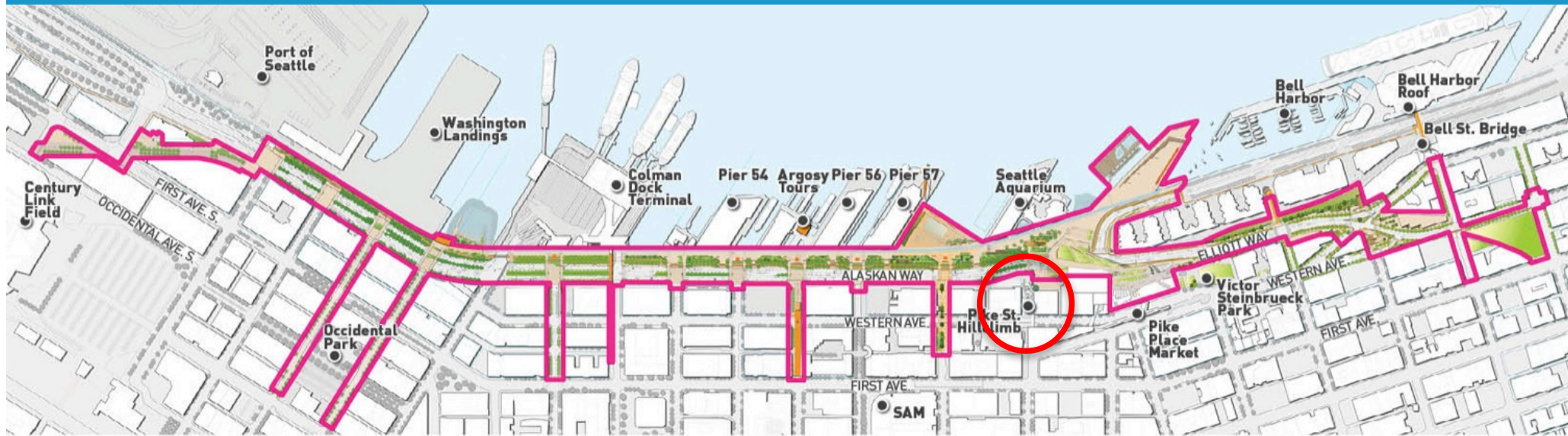



# A BLANK CANVAS

# Pike Street Hill Climb: Evergreen Passage



**Hill Climb**, Seattle, WA

RICH AND GRAPHIC PLANTING



Hill Climb, Seattle, WA

# Ideas?

Visit us at  
Waterfront Space  
1400 Western Avenue

[www.FriendsOfWaterfrontSeattle.org](http://www.FriendsOfWaterfrontSeattle.org)

An aerial photograph of the Seattle waterfront, showing the city skyline, the waterfront area with a large ferry terminal, and the water. The image is overlaid with a semi-transparent blue filter. The logo for 'Friends of Waterfront Seattle' is centered in the image. The word 'friends' is in a large, white, lowercase sans-serif font, with the letter 'e' highlighted in yellow. Below it, the words 'of WATERFRONT SEATTLE' are in a smaller, white, uppercase sans-serif font.

friends  
of WATERFRONT SEATTLE